



TECHNISCHE  
UNIVERSITÄT  
DRESDEN

Faculty of Computer Science Institute of Systems Architecture

Faculty of Computer Science

Master's Programme in  
'Distributed Systems Engineering'

Dr.-Ing. Tenshi Hara  
[tenshi.hara@tu-dresden.de](mailto:tenshi.hara@tu-dresden.de)

# TU Dresden

(Statistics as of 2014/2015)

- Saxony's largest University
- 6 Profiles, 14 Faculties, 5 Schools
- 36,737 Students
  - 10,588 in Engineering (i.e. 28.8%)
  - 5,852 Juniors
- 126 Degree Programmes
- 8,364 Employees (3,766 on Third-Party Funds)
- 242.4 Mil EUR Third-Party Funds

TU Dresden

Technische Universität Dresden

TU Dresden

University Medical Centre  
'Carl Gustav Carus'

Wind Tunnel

Botanical Garten

Main Campus

# The Research Network 'DRESDEN-concept e.V.'

## Technische Universität Dresden

### Fraunhofer-Gesellschaft

Institut für Werkstoff- und Strahltechnik  
 Institut für Photonische Mikrosysteme  
 Institut für Keramische Technologien und Systeme  
 Institut für Elektronenstrahl- und Plasmatechnik

### Max-Planck-Gesellschaft

Institut für molekulare Zellbiologie und Genetik  
 Institut für Physik komplexer Systeme  
 Institut für Chemische Physik fester Stoffe

## Leibniz-Gemeinschaft

Institut für Polymerforschung Dresden  
 Institut für Festkörper- und Werkstoffforschung Dresden  
 Institut für ökologische Raumentwicklung

## Helmholtz-Gemeinschaft

Forschungszentrum Dresden-Rossendorf

## Museen und Bibliotheken

Staatliche Kunstsammlungen Dresden  
 Deutsches Hygiene-Museum  
 Sächsische Landesbibliothek – Staats- und Universitätsbibliothek Dresden



# TU Dresden

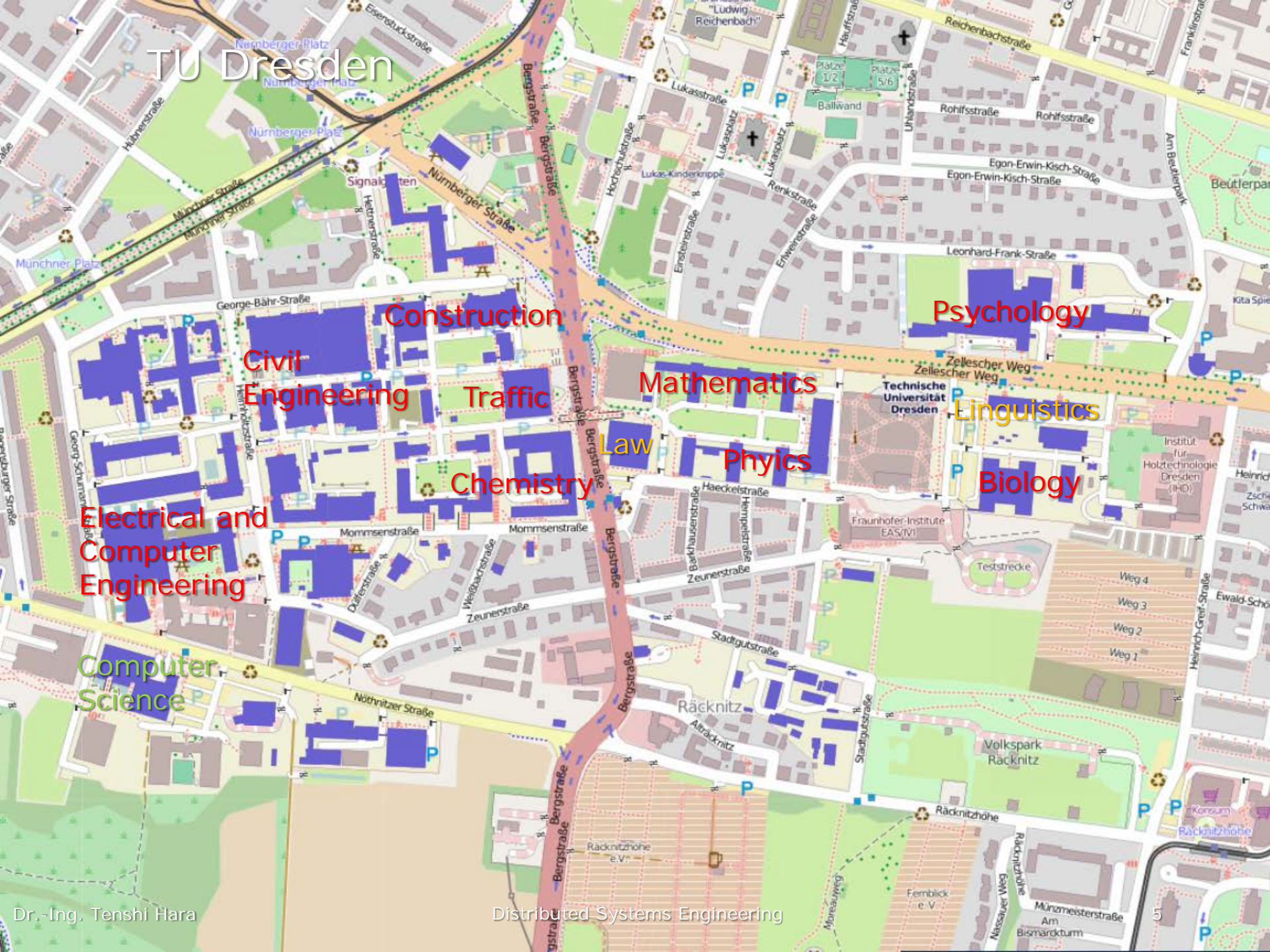

Electrical and  
Computer  
Engineering

Civil  
Engineering

Construction

Chemistry

Traffic

Law

Mathematics

Physics

Biology

Linguistics

Psychology

Computer  
Science

# Faculty of Computer Science

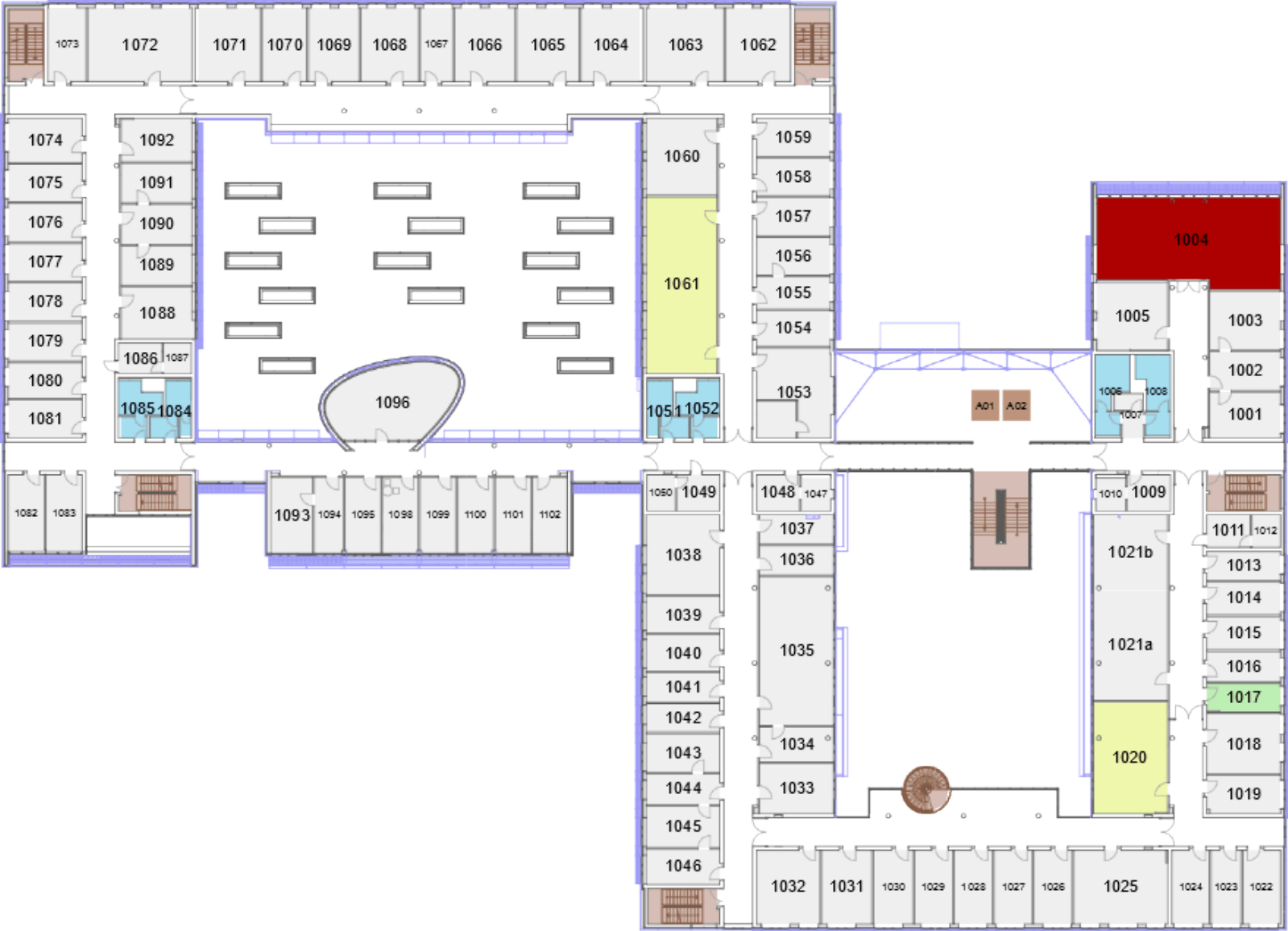

# Faculty of Computer Science

(Statistics as of 2014/2015)

- 6 Institutes
- 25 Chairs, 3 Senior-Professorships
- 280 Employees (138 State HR Budget)
- 1,919 Students
- 200+ Research Areas
- ~10.9 Mil EUR Third-Party Funds in 2014
- 211 Doctorate Students 2015
- 26 Doctorate Conferrals 2015



# Large-Scale Research Projects

- **cfAED** – ‘Centre for Advancing Electronics Dresden’
  - 7 Chairs from Computer Science
  - Budget: Excellence Initiative
- **SFB 912 HAEC** – Highly-adaptive Energy Efficient Computing
  - 7 Chairs and 1 Priv.-Doz. from Computer Science
  - Budget: DFG
- **ResUbic Lab Dresden** – Cyber-Physical Systems
  - 5 Chairs from Computer Science
  - Budget: EU (ESF) and SMWK
- **QuantLA, EPCL, IT4BI, RoSI**
  - 4 structured Ph.D. Programmes
  - financed by DFG, DAAD and EU

# Numbers by Degree Programme

(Statistics as of 2015/2016)

		Total	Juniors
Computer Science	Diploma	423	81
	Bachelor	401	144
	Master	116	39
Media Computer Science	Diploma	56	0
	Bachelor	406	152
	Master	96	24
Teaching Post	Bachelor	5	0
	State Exam	113	43
	Master	12	0
Computational Science and Engineering	Master	12	8
Computational Logic	Master	54	38
Distributed Systems Engineering	Master	63	19
Doctorate		108	14
<b>Total</b>		<b>1,919</b>	<b>591</b>

# Institutes and Chairs

## Applied Computer Science

- Human Computer Interaction
- Industrial Communications
- Modeling and Simulation
- Technical Information Systems

## Artificial Intelligence

- Applied Knowledge Representation and Reasoning
- Computational Logic
- Computer Vision
- Scientific Computing for Systems Biology
- Knowledge Representation and Reasoning

## Software and Multimedia Technology

- Computer Graphics and Visualisation
- Didactics of Computer Science
- Media Design
- Multimedia Technology
- Software Technology

## Computer Engineering

- Compiler Architecture
- Computer Construction
- Embedded Systems
- Processor Design
- VLSI Design Systems, Diagnostics and Architecture

## Systems Architecture

- Computer Networks
- Databases
- Operating Systems
- Privacy and Data Security
- Systems Engineering

## Theoretical Computer Science

- Algebraic and Logical Foundations of Computer Science
- Automata Theory
- Foundations of Programming
- Knowledge-Based Systems

# DSE Master's Degree Programme

- 2-year full-time programme
- focusing on advanced topics of distributed (software) systems engineering:
  - Specification
  - Design\*
  - Analysis
  - Development\*
  - Operation

\* special emphasis on secure software for networked and distributed systems

# Service Center for International Students

## Examination Office for DSE students

- registration to examinations
- administration of exam results
- announces the grades
- issues transcripts of records and confirmation documents

Room: APB/2018

Hours: WE & FR 9:30a till 11:30a

E-Mail: [infscis.dse@mailbox.tu-dresden.de](mailto:infscis.dse@mailbox.tu-dresden.de)

Web: [https://www.inf.tu-dresden.de/index.php?node\\_id=2728&ln=en](https://www.inf.tu-dresden.de/index.php?node_id=2728&ln=en)

**Always bring ID and matriculation certificate!**  
Student ID alone is insufficient.

# Important contacts

Mr. Prof. Christof Fetzner

Professor of Systems Engineering

DSE Programme Coordinator (Dean)

Room APB/3104

[christof.fetzner@tu-dresden.de](mailto:christof.fetzner@tu-dresden.de)

[+49-351-463-39709](tel:+49-351-463-39709)

Hours: TU 9a – 10a

Mr. Prof. Alexander Schill

Professor of Computer Networks

Chairman of the Examination Board

Room APB/3111

[alexander.schill@tu-dresden.de](mailto:alexander.schill@tu-dresden.de)

[+49-351-463-38261](tel:+49-351-463-38261)

Hours: by appointment

Application of

- deadline extensions (especially for thesis submission deadline)
- third attempt exams (2<sup>nd</sup> repetition)
- approval of (external) programme achievements

# Help during the semester

Ms Dr.-Ing. Irina Karadschow

Ms Claudia Einert

Chair of Systems Engineering

Secretaries to Prof. Fetzer

Room APB/3107

[se@mailbox.tu-dresden.de](mailto:se@mailbox.tu-dresden.de)

[+49-351-463-39708](tel:+49-351-463-39708)

Hours: TU 9a – 11a

TH 1p – 3p

Web:

<http://dse.inf.tu-dresden.de>

Ms Anja Fischer

Service Center for International Students

Coordinator

Room APB/2018

[infscis.dse@mailbox.tu-dresden.de](mailto:infscis.dse@mailbox.tu-dresden.de)

[+49-351-463-39240](tel:+49-351-463-39240)

Hours: WE & FR 9:30a – 11:30a

Mr Dr.-Ing. Tenshi Hara

Chair of Computer Networks

DSE Studies Advisor

Room APB/3085

[tenshi.hara@tu-dresden.de](mailto:tenshi.hara@tu-dresden.de)

[+49-351-463-38381](tel:+49-351-463-38381)

Hours: FR 9a – 12p w/o apmt.

FR 1p – 4p apmts. only

# Mandatory Modules

## 4 mandatory Lecture Series (30 CP)

- Systems Engineering (9 CP)
- Ubiquitous Systems (7 CP)
- Transactional & Secure Platforms (9 CP)
- System Design (5 CP)

## 1 mandatory Internship (12 CP)

- 2 Complex Practicals (each 6 CP), or
- 1 Assignment Paper (12 CP)

## 1 mandatory Master Thesis (29 CP + 1 CP)



# Elective Modules

## 14 elective Lecture Series (your pick of 48 CP)

- Advanced Security and Cryptography (6 CP)
- Wireless Sensor Networks (6 CP)
- Distributed Operating Systems (6 CP)
- Component-based Software Engineering (6CP)
- Selected Areas of Internet-based Systems (2x 6 CP out of 4x 6 CP)
- Concurrent and Distributed Systems (2x 6 CP)
- Software Fault Tolerance (2x 6 CP + 3 CP)
- Microkernel-based Operating Systems (6 CP)
- Real-Time Systems (6 CP)
- Application Development for Mobile & Ubiquitous Computing (6 CP)
- Principles of Dependable Systems (6 CP + 3 CP)
- Foundations of Computational Logic (2x 4,5 CP)
- Advanced Topics in Systems Architecture (3 CP)
- Advanced Topics in Distributed Systems (6 CP)

# Recommended Schedule

Semester	DSE-M1	DSE-M2	DSE-M3	DSE-M4	DSE-Int	DSE-E1	DSE-E2	DSE-E3	DSE-E4	DSE-E5	DSE-E6	DSE-E7	DSE-E8	DSE-E9	DSE-E10	DSE-E11	DSE-E12	DSE-E13	DSE-E14	Master Thesis	CP
1 <sup>st</sup>	◇	◇	◇	◇																	30
2 <sup>nd</sup>						?	?	?	?	?	?	?				?					30
3 <sup>rd</sup>					◇							?	?	?	?	?	?	?	?		30
4 <sup>th</sup>																				◇	30
	42					48										30	120				

◇ mandatory module

◆ elective module

# This Semester

All mandatory lectures are offered this semester

- DSE-M1
  - Systems Engineering I Prof. Fetzner
  - Systems Engineering II Prof. Fetzner
- DSE-M2
  - Mobile Communication and Mobile Computing Prof. Schill, Dr. Springer, PD Dr. Dargie
  - Distributed Systems Prof. Schill, Dr. Springer, Dr. Braun
  - Transactional Information Systems Prof. Lehner, Dr. Hahmann
- DSE-M3
  - Security and Cryptography I Prof. Strufe, Dr. Köpsell
- DSE-M4
  - Design-Patterns and Frameworks Prof. Aßmann

Period	MO	TU	WE	TH	FR
1		Tutorial <i>Systems Engineering II</i> APB/E023			
2		Tutorial <i>Distributed Systems</i> APB/E023		Lecture <i>Security and Cryptography I</i> APB/E023	
3	Lecture <i>Systems Engineering I</i> APB/E023			Lecture <i>Security and Cryptography I</i> APB/E023	Tutorial <i>Systems Engineering I</i> APB/E023
4	Lecture <i>Transactional Information Systems</i> APB/E023	Tutorial <i>Transactional Information Systems</i> APB/E001		Lecture <i>Mobile Communication and Mobile Computing</i> APB/E023	
5	Lecture <i>Systems Engineering II</i> APB/E023	Lecture <i>Design Patterns and Frameworks</i> APB/E023	Tutorial <i>Design Patterns and Frameworks</i> WIL/C129		
6	Complete time table incl. elective modules: <a href="http://web.inf.tu-dresden.de/Fak/w/16/studiengang/studiengang_dse_2014.html">http://web.inf.tu-dresden.de/Fak/w/16/studiengang/studiengang_dse_2014.html</a>			Lecture <i>Distributed Systems</i> SCH/OA01	

# Time Table

Lectures, Seminars, Practicals, et cetera take place

- October till January      Winter Semester
- April till July              Summer Semester
- Monday through Friday (officially also on Saturday)
  - 1st period                      7:30a    till 9a
  - 2nd period                      9:20a    till 10:50a
  - 3rd period                      11:10a   till 12:40p
  - 4th period                      1p        till 2:30p
  - 5th period                      2:50p    till 4:20p
  - 6th period                      4:40p    till 6:10p
  - 7th period (rarely)          6:30p    till 8p

Pay attention to holidays, et cetera!

<https://tu-dresden.de/studium/im-studium/studienorganisation/studienjahresablauf>

# Terminology

**SWS Semesterwochenstunde** (Semester Weekly Hour)

1 SWS equals to 1 weekly 45-minute session for 14 weeks  
(additional 45 minutes of weekly outwork)

usually given for lectures, tutorials and practicals (V/Ü/P)

e.g.: Systems Engineering I – 2/2/- or 2/2/0

weekly 90-minute lecture,

weekly 90-minute tutorial,

no practical

Periods are **always 90 minutes!**

Uneven SWS mean fouthnightly sessions. Pay attention to the week numbers (even/uneven).

This week is even (40th week of the year).

# Enrollment

Most of the offered lectures, tutorials and practicals require mandatory enrollment.

Please use the online enrollment systems provided by jExam:

<https://jexam.inf.tu-dresden.de/de.jexam.web.v4.5/spring/welcome?lang=en>

Foreign language courses offered by LSK/TUDIAS (not for German courses!):

<https://lskonline.tu-dresden.de/lskonline/de/102.0.1>

# Exams

Taken either as written or oral exam.

→ Refer to module description or ask lecturer

- register IN PERSON at SCIS
  - during the registration period (written exam)
  - latest two weeks prior to exam (oral exam)
- for oral exams:
  - ask examiner for available appointments
  - go to SCIS and register for the exam
  - present SCIS paper-work to examiner and make the actual exam appointment
- cancellation is possible BEFORE the examination latest
  - three days (written exam)
  - two weeks (oral exam)
- after cancellation deadline, you must present a sickness certificate to the SCIS issued on the day of examination or before stating you were unable to take the exam



# Should you fail an exam

## Keep calm!

- you may repeat a failed exam twice
  - first repetition within one year
  - second repetition within the next examination period
  - only after three failed attempts you will drop out
- you need to apply for the second repetition and receive a permit from the examination board
- you may present a sickness certificate if you were ill during an exam, nullifying the failed attempt  
(needs to be hand-in within three days of the exam)

## Careful, these automatically lead to non-passing grade (5,0):

- failure to register for repetition in due time
- no-show without sickness certificate or very good reason  
(flood, tornado, earthquake, ...)

# Good to know

## Mailing-List ([dse2016@ifsr.de](mailto:dse2016@ifsr.de))

- register at <https://lists.ifsr.de/listinfo/dse2016>
- important information and news (especially from SCIS)
- ask questions and engage in discussions

## International Office

- provides help with all kinds of problems (VISA, government, dormitory, ...)
- good community for international exchange

## Re-registration

- re-register with the matriculation office every semester
- pay the semester contribution on time
- **without re-registration you will automatically drop-out**

# Campus Life

# SLUB – State and University Library

- Central Library (main building):  
Zellescher Weg 18 (#47a on TUD map)
- Departmental Library ('DrePunct' building):  
Zellescher Weg 17 (#47c on TUD map)
- registration with
  - online form in advance
  - matriculation certificate
  - passport
- service is free for registered students
- additional services: WLAN, copy machines
- information at: <http://www.slub-dresden.de>

# IT Services provided by ZIH

## Computer Labs (ground level, west wing)

- personal login and first password on semester print-out sheet
- operating hours of computer labs
  - weekdays: 7a till 9:30p
  - weekend: 10a till 5:30p

## E-mail

- E-mail address on semester print-out sheet; in general: givenname.surname@mailbox.tu-dresden.de
- comes with Unix-mail (IMAP, POP3) and Exchange access
- make sure to set-up account with your mail programme, or set-up a forward (instructions on ZIH website), and check the inbox regularly
- **important messages from the university are sent to this address only**  
'I did not receive the E-Mail' is not a valid excuse if you miss an exam, et cetera!

# Refectories

You can pay with EC-card or cash, but Emeal is the convenient choice.

- without Emeal you must show your student ID with each purchase in order to receive student discounts!
- in cafeterias 3% discount
- deposit of 5 EUR
- registration with
  - passport
  - student ID
  - Emeal certificate  
(on semester print-out sheet)
- several refectories at main campus  
nearest one:  
Alte Mensa Mommsenstr. (#24a on TUD map)



## Extra-curricular activities

Information around study and living:

<http://www.studydresden.com>

## Sports

- registration online  
(starts next Tuesday, 11 October)
- <http://tu-dresden.de/usz>
- small fee per semester

## LinkPartner

- find a German Link Partner
- check out:  
<http://www.linkpartnerprogramm.de>

# German Courses

## VHS Basic Course, Level A1

- <http://www.vhs-dresden.de/?id=189>
- Adult Education Centre Dresden



## TUDIAS Basic Course, Level A1

- course fee: 360€ excl. learning material
- e.g., 7 Nov 16 till 30 Jan 2017 (part 1)  
and 1 Feb 2017 till 10 Apr 2017 (part 2)
- 80 teaching units
- twice per week (5p till 8:15p; 8h per week)
- online registration:  
[http://www.tudias.de/en/Deutsch\\_fuer\\_Auslaender/Deutsch\\_fuer\\_Alltag\\_und\\_Beruf/sk\\_intensivkurse.html](http://www.tudias.de/en/Deutsch_fuer_Auslaender/Deutsch_fuer_Alltag_und_Beruf/sk_intensivkurse.html)







Thank you.

Any questions?